

## SPECIFICATION CONTROL DRAWING

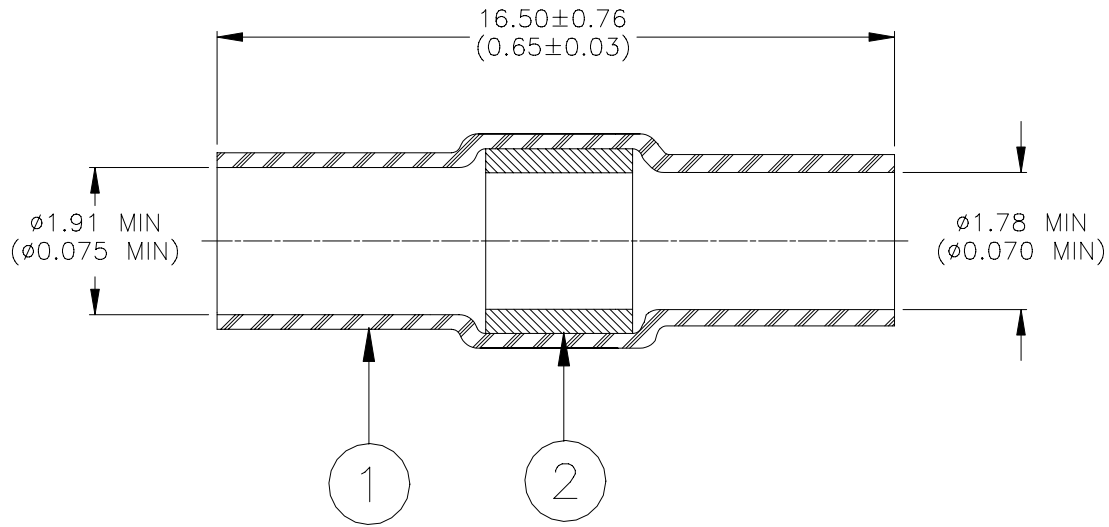

### MATERIALS

1. INSULATION SLEEVE: Heat-shrinkable, transparent blue, radiation cross-linked modified polyvinylidene fluoride.
2. SOLDER PREFORM WITH FLUX:  
 SOLDER: TYPE Sn63 per ANSI J-STD-006.  
 FLUX: TYPE ROL1 per ANSI-J-STD-004.

### APPLICATION

1. This part is designed for splicing two tin plated conductors having a combined maximum diameter of 1.78 (0.07) and a minimum jacket diameter of 1.02 (0.04).
2. Part may be installed with infrared or convection heat sources.
3. Wires are to be stripped 7.62 to 10.16 (0.30 to 0.40) and overlapped under the solder preform.

<b>Raychem Interconnect</b> <small>a division of tyco ELECTRONICS</small> 300 Constitution Drive Menlo Park, CA 94025, USA		THERMOFIT DEVICES	TITLE: <b>SOLDERSLEEVE CONDUCTOR SPLICE, 1.78 (0.070) I.D.</b>				
UNLESS OTHERWISE SPECIFIED DIMENSIONS ARE IN MILLIMETERS. INCHES DIMENSIONS ARE BETWEEN BRACKETS.			DOCUMENT NO.: <b>D-110-0079</b>				
TOLERANCES: 0.00 N/A 0.0 N/A 0 N/A	ANGLES: N/A  ROUGHNESS IN MICRON	Raychem reserves the right to amend this drawing at any time. Users should evaluate the suitability of the product for their application.	DCR NUMBER: D990725	REPLACES: N/A			
DRAWN BY: M. FORONDA	DATE: 06-July-00	PROD. REV. A	DOC ISSUE: 1	SCALE: None	SIZE: A	SHEET: 1 of 1	

If this document is printed it becomes uncontrolled. Check for the latest revision